

Tolerance
h7

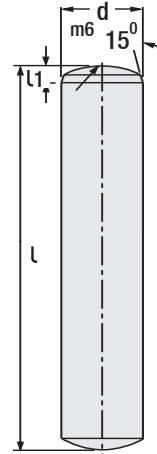

Tolerance
m6



Dowel Pin
Straight - DIN 6325 / ISO 9734

Code: **DTPH7**

d	l	l1	r	d	l	l1	r	d	l	l1	r
Ø 5 mm	10	1.2 mm	5	Ø 8 mm	40	2.0 mm	8	Ø 14 mm	30	3.5 mm	14
	16										
	20										
	24										
	30										
	36										
	40										
	45										
	50										
	55										
	60										
	70										
80											
90											
100											
120											
Ø 6 mm	10	1.5 mm	6	Ø 10 mm	20	2.5 mm	10	Ø 16 mm	30	4.0 mm	16
	16										
	20										
	24										
	30										
	36										
	40										
	45										
	50										
	55										
	60										
	70										
80											
90											
100											
120											
140											
Ø 8 mm	10	2.0 mm	8	Ø 12 mm	20	3.0 mm	12	Ø 20 mm	30	5.0 mm	20
	16										
	20										
	24										
	30										
	36										
	40										
	45										
	50										
	55										
	60										
	70										
80											
90											
100											
120											
140											



Order: **DTPH7. d x l**

Material: 1.7131 (16MnCr 5)
Hardness: 60 - 62 HRC (Depth 0.8)

Dowel Pin
Straight - DIN 6325 / ISO 9734

Code: **DTPm6**

d	l	l1	r	d	l	l1	r	d	l	l1	r
Ø 3 mm	10	0.8 mm	3	Ø 8 mm	10	2.0 mm	8	Ø 14 mm	30	3.5 mm	14
	16										
	20										
	24										
	30										
	36										
	40										
Ø 4 mm	10	1.0 mm	4	Ø 10 mm	20	2.5 mm	10	Ø 16 mm	30	4.0 mm	16
	16										
	20										
	24										
	30										
	36										
	40										
	45										
	50										
	55										
	60										
	70										
80											
90											
100											
120											
Ø 5 mm	10	1.2 mm	5	Ø 12 mm	20	3.0 mm	12	Ø 20 mm	30	5.0 mm	20
	16										
	20										
	24										
	30										
	36										
	40										
	45										
	50										
	55										
	60										
	70										
80											
90											
100											
120											
140											
Ø 6 mm	10	1.5 mm	6	Ø 14 mm	20	3.5 mm	14	Ø 22 mm	30	6.0 mm	22
	16										
	20										
	24										
	30										
	36										
	40										
	45										
	50										
	55										
	60										
	70										
80											
90											
100											
120											
140											



Order: **DTPm6. d x l**

Order Example:

DTPm6. 10 x 30