

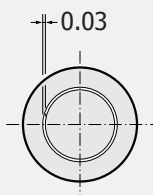

Double Air Valve

Code: **VD**

An effective method of semi pneumatic ejection, for moulds with ribs (in thin walled mould) or areas forming gas traps or vacuum conditions. Helps part ejection with air. Allows venting.

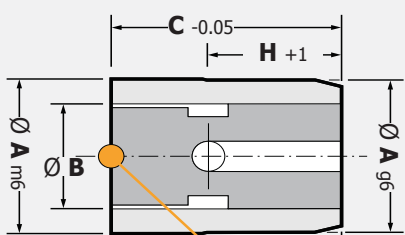

Material: INOX 1.4034
Hardness: 51 ± 3 HRC

Code: **VD**

Order	A	B	C	E	H
VD.080512	8	5	12	4	7
VD.100612	10	6	12	5	7
VD.120812	12	8	12	7	7
VD.161020	16	10	20	9	12

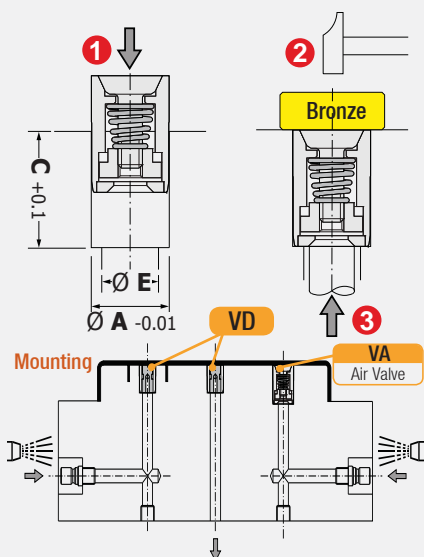

Sprue Adjuster

Code: **SA**

It is suitable to use on high injection pressure and fast / mass production stamps. This unit allows runner shut off directly from the parting line. Two models are available, depending if an ejector pin is required or not. It can be installed in the cavity or in the core, allowing trapezoidal or full round runners.

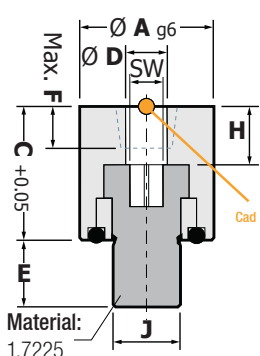

Material: INOX 1.4034
Hardness: 48 ± 3 HRC
Max. working temp.: 100°

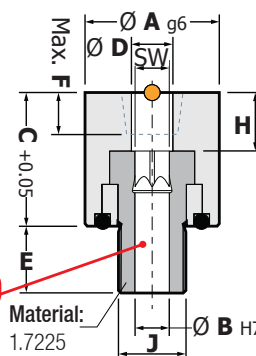

With Ejector Bore

Order	A	C	D	E	F	H	J	SW
SA.120014	12	14	4	6	3	5	M6	3
SA.160016	16	16	5	8	5	7	M8	4
SA.200018	20	18	6	10	6	9	M10	5

Order	A	B	C	D	E	F	H	J	SW
SA.120314	12	3	14	4	6	3	5	M6	3
SA.160416	16	4	16	5	8	5	7	M8	4
SA.200518	20	5	18	6	10	6	9	M10	5

Runner Position Configurations

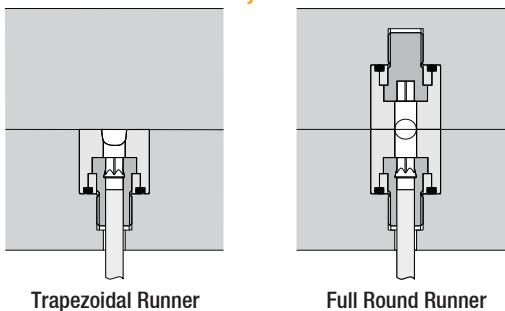

Runner Adjuster

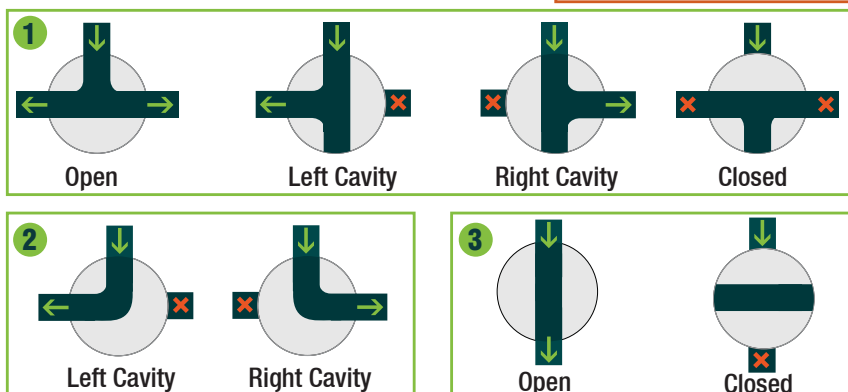
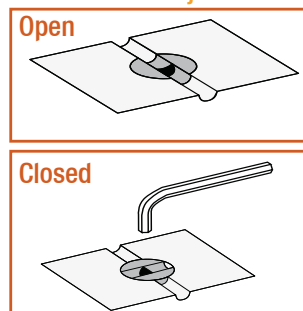

CUMSA
End of Cumsa Products Section...