

Die Lifters "DL50" & "DB50" / Hydraulic

Code: **DL50 & DB50**

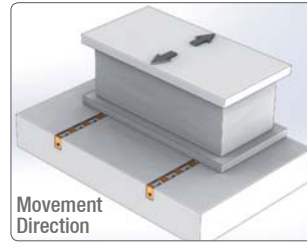

Code: DL50 (with rollers)

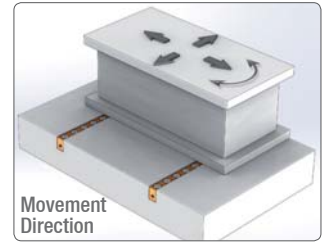

Code: DB50 (with balls)

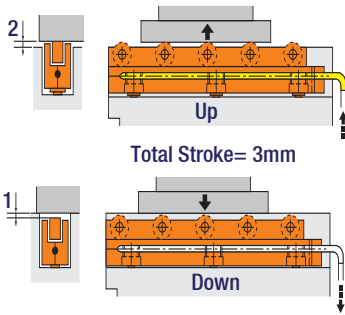

Standard Temperature: 60°
Optional Temperature: 160°

Order: **Code. Type**

Order Example:
DL50. 1020-0300

Dimensions before "L: 2100 mm":

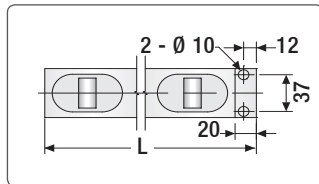

Outer Dimensions DL50 & DB50

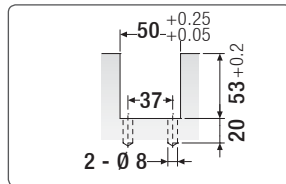

Machining Method for Plate

Dimensions "L: 2100 mm" and after:

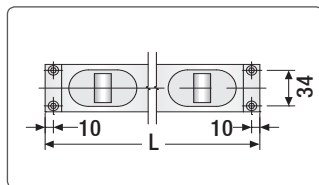

Outer Dimensions DL50 & DB50

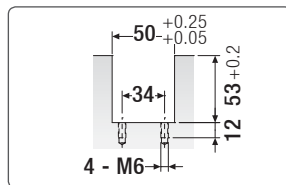

Machining Method for Plate

Type	L (mm)	DL50		DB50		Hyd. Cylinder	
		Roller	Capacity	Ball	Capacity	Piston	Capacity
1020-0200	200	2 pcs	1000 kg	4 pcs	640 kg	2 pcs	2200 kg
1020-0300	300	3	1500 kg	6	960 kg		
1020-0400	400	4	2000 kg	9	1440 kg		
1020-0500	500	5	2500 kg	11	1760 kg	3	3300 kg
1020-0600	600	6	3000 kg	13	2080 kg		
1020-0700	700	7	3300 kg	16	2560 kg		
1020-0800	800	8	3300 kg	18	2880 kg	4	4400 kg
1020-0900	900	9	4400 kg	20	3200 kg		
1020-1000	1000	10		23	3680 kg		
1020-1100	1100	11		25	4000 kg		
1020-1200	1200	12	5500 kg	27	4320 kg	5	5500 kg
1020-1300	1300	13		29	4640 kg		
1020-1400	1400	14		31	4960 kg		
1020-1500	1500	15	6500 kg	33	5280 kg	6	6600 kg
1020-1600	1600	16		35	5600 kg		
1020-1700	1700	17		38	6080 kg		
1020-1800	1800	18	7700 kg	40	6400 kg	7	7700 kg
1020-1900	1900	19		42	6720 kg		
1020-2000	2000	20		44	7040 kg		
1020-2100	2100	21	8800 kg	46	7360 kg	8	8800 kg
1020-2200	2200	22		48	7680 kg		
1020-2300	2300	23		50	7700 kg		
1020-2400	2400	24	8800 kg	52	8320 kg	8	8800 kg
1020-2500	2500	25		54	8640 kg		



Technical Support for Quick Die & Mould Change Systems



You can request the "Quick Die & Mould Change Systems Information Form" from us or you can download it directly from Guvenal web-site. The form filled by you will be examined by our engineers and the most suitable method will be produced for you.

* * *

We are supporting you with customizable offers about technical and costing issues of your projects and we are producing the best solutions.

support@guvenal.net • www.guvenal.net