

Shapes

BHY

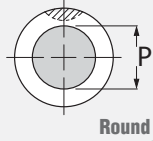

BHO

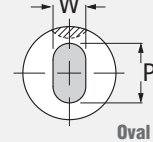

BHK

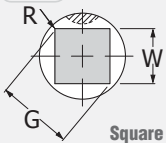

BHD

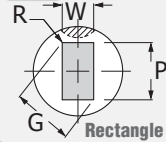

BHA

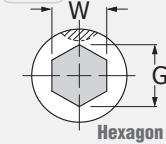

BHM

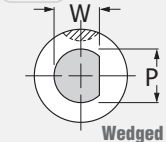

BHX

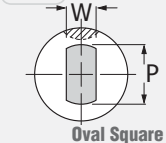

BHP

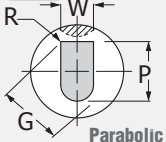

Standard Position

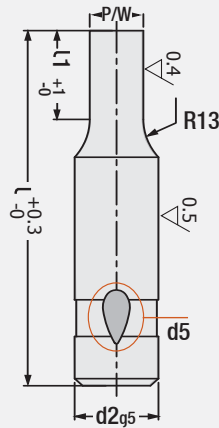
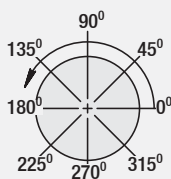

LIGHT DUTY



Ball Lock Stepped Punch - Light Duty

Code: **BH..**

Material: 1.3343 (M2) - Hardness: 60 - 62 HRC

- When P = d2 shank / body tolerances apply.
- Standard ball socket location is at 90°.

Order d2	Ball Socket d5	Shape		Standard l1	Alternative l1		l mm
		(BHY) Round P	Other Shapes W G/P		Min.	Max.	
BH..06	6	2.2 ~ 5.9	2.2 - 5.9	13	10	-	63
BH..10	8 mm	2.5 ~ 9.9	2.5 - 9.9	19	10	19	71
BH..13		5.0 ~ 12.9	4.5 - 12.9	19	13	25	80
BH..16		8.0 ~ 15.9	6.0 - 15.9	19	13	25	90
BH..20		12 ~ 19.9	8.0 - 19.9	19	13	25	100
BH..25		16 ~ 24.9	10 - 24.9	19	13	25	125
BH..32		24 ~ 31.9	12.5 - 31.9	25	25	30	80
BH..38		30 ~ 37.9	14 - 37.9	25	25	30	90
							100
							125

Order Codes: **BHY - BHO - BHK - BHD - BHA - BHM - BHX - BHP**

← Please refer to the table on the left side

How to order:

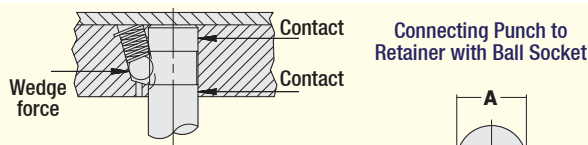
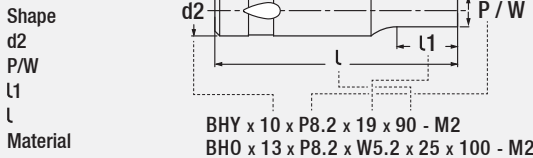

Requirements of Ball Locking Place

Punch Dia. A	Ball Dia. B	Clearance C
6.0	6.0	10
10		
13		
16		
20		
25	8	11
32		
38		

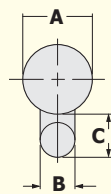

for precise retainers, please add 1.7 to "C" dimension

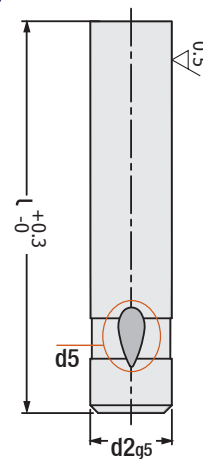

LIGHT DUTY



Ball Lock Punch - Light Duty

Code: **BHZ**

ISO 10071

(Blank type)

Body and cutting edge are precision ground. Also, full or partial coating can be preferred upon request, by providing resistance against heat and friction on external layer, it solves problems such as winding and cold welding.

d2	d5	l	d2	d5	l
Ø 6 mm	6 mm	63	Ø 20 mm	8 mm	63
		71			71
		80			80
		90			90
		100			100
		125			125
Ø 10 mm	8 mm	63	Ø 25 mm	8 mm	63
		71			71
		80			80
		90			90
		100			100
Ø 13 mm	8 mm	63	Ø 32 mm	8 mm	71
		71			80
		80			80
		90			90
		100			100
		125			125
Ø 16 mm	8 mm	63	Ø 38 mm	8 mm	80
		71			80
		80			90
		90			100
		125			125

Order: **BHZ. d2 x l**

Material: 1.3343 (M2)
Hardness: 60 - 62 HRC

Note: Special dimensions on request.