

### Gerı Vurucu -Vıdalı KOLON Kod: G 16

Plastık Kalıp, Enjeksiyon Bađlantısı

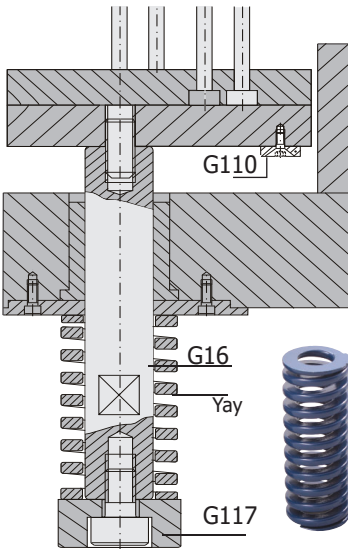

Sipariř: G16. d x l

Malzeme: <math>\varnothing 20 = 1.7131</math>  
>  $\varnothing 20 = 1.1213 (Cf53)</math>  
Sertlik: 58 - 62 HRC$

### Gerı Vurucu KOLON Kod: G 16

d	L	d1	l1	l2	l3	l4	SW
10	60	M.6	10	14	21	10	8
	70						
	80						
	100						
14	60	M.8	13	16	21	10	10
	80						
	100						
	120						
	140						
16	60	M.10	16	20	21	10	12
	70						
	80						
	100						
	120						
	140						
18	100	M.10	20	26	30	10	14
	120						
	140						
	160						
	180						
	200						
	220						
240							
20	120	M.12	24	30	40	16	14
	140						
	160						
	180						
	200						
24	120	M.12	24	30	40	16	17
	140						
	160						
	180						
	200						
	240						
34	160	M.16	34	40	50	16	24
	200						
	240						
	260						
	300						

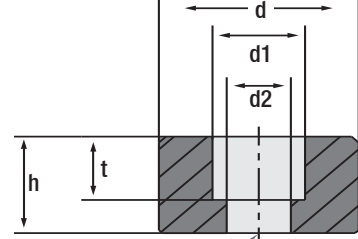

IMB / İmbus Cıvata

### Stoplama Pulu Kod: G 117

d	h	t	d1	d2
15	10	8.4	11	6.6
22	14	11	14.5	9
36	20	13.5	17.5	11
46	25	15.5	20	14
56	32	21	26	18



Sipariř: G117. d x h

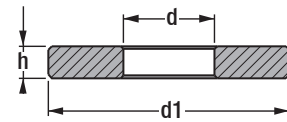

### Kalıp İi Montaj Pulu

DIN 6340 Kod: G 114

Form	d	d1	h	Ađırlık
M6	6.4	17	3	6 gr.
M8	8.4	23	4	10 gr.
				16 gr.
M10	10.5	28	5	35 gr.
M12	13	35		40 gr.
M14	15	40	6	60 gr.
M16	17	45		75 gr.
M18	19	50		
M20	21	50		



Sipariř: G114. Form