



Plain Guide Bush for Ball Cage ISO 9448-3

Code: **G167**

The inner diameter of the products is honed, the outer diameter is precision ground. The grooves on the product are made to provide better adhesion to the hole during mounting.

Advantages of G167: No problem finding the position when changing the bushes. High accuracy and robustness.

Mounting Instruction:

Please secure with adhesive (**Order Code:** GL.64832)
Do not press-fit.

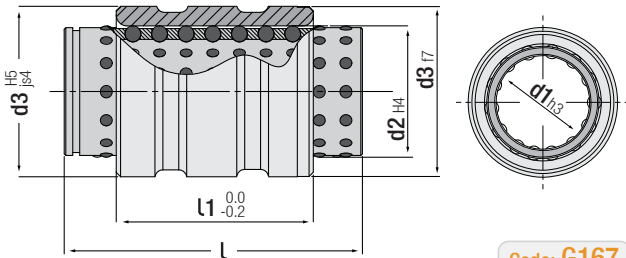

Code: **G167**

d1 mm	d2 mm	d3 mm	l1 mm	l mm
12	16	22	23	40
			30	40
			37	40
15	21	28	23	45
			30	45
			37	45
16	22	28	47	56
			60	71
			77	95
19	25	32	23	45
			30	45
			37	45
20	26	32	47	56
			60	71
			77	95
24	30	40	23	45
			30	45
			37	45
25	31	40	47	56
			60	71
			77	95

d1 mm	d2 mm	d3 mm	l1 mm	l mm
30	38	48	30	45
			37	50
			47	56
			60	71
32	40	48	77	95
			95	120
			30	45
			37	50
38	46	58	47	63
			60	80
			77	95
			95	120
40	48	58	120	140
			37	50
			47	63
			60	80
48	56	70	77	95
			95	120
			120	140
			37	50
50	58	70	47	63
			60	80
			77	95
			95	120
60	68	85	120	140
			60	95
			77	95
			95	120
63	71	85	120	140
			120	140
			120	140
80	92	105	120	140

Note: Ball Cage "G70" must be ordered separately.

Order: **G167. d1 x l1**

Material: 1.7131
Hardness: 60 - 64 HRC



Limiting Bush

Code: **G168**

It helps to position the working length of the bushes running on the guide pillars.

Mounting Example

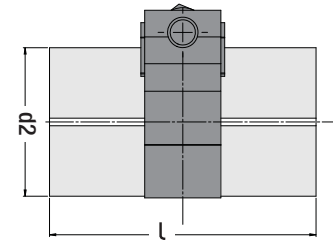
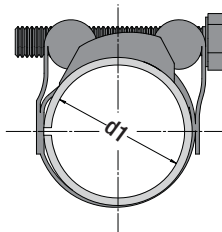

Guide Pillar Ø	d1 mm	d2 mm	l mm
15 / 16	16	20	20
19 / 20	20	30	20
24 / 25	25	30	30
30 / 32	32	40	30
38 / 40	40	50	40
48 / 50	50	60	40
60 / 63	63	70	40

Order: **G168. d1**

Order Example: **G168. 40**



Adhesive / Loctite 648

The adhesive provides optimum push retention for "G167" bushes. For adhesion of bearings, bushes, screws and other machine components. Very fast adhesion to handling strength.

Heat Resistance: -55° / +175° C

Package: 55 g.

Order Code: **GL.64832**