



Code: CG

Adjustable Wedge Assembly (Heel Unit & Including Pin)

It is consisted of angular pin and locking thrust wedge. While mould is closed, it can be easily adjusted with allen key. All machining is made 90° to the parting line. Parts can be replaced from the parting line. Angle pin included in CG - SET. Hardened steel pre-adjusted for immediate use. Hardened wear plate.

Material: 1.2312
 ≈ 1.080 N/mm².
 Patented System

Attention!
 Standard stroke
 of 12mm.

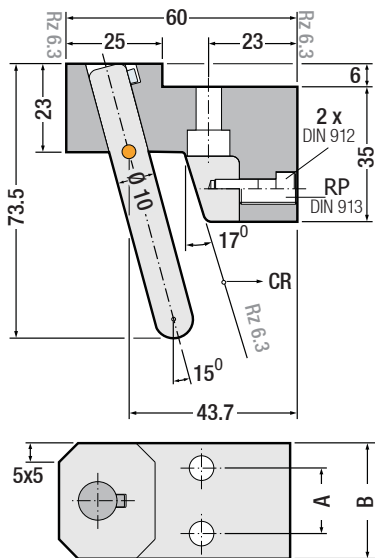

Order	A	B
CG.603075	17	30
CG.604075	22	40

CR (N)	RP (Screw)	Angle Pin
180.000	081015	GI.010075
320.000	101015	GI.010075

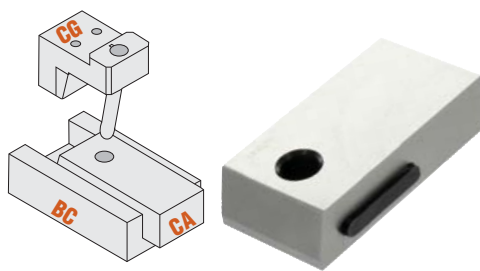

Code: CA

Adjusted Slide

Interchangeable and completely adjusted, only requires the part detail to be machined. Its rectangular shape simplifies machining. Angular hole is drilled on slide.

Material: 1.2344
Hardness: 42 ± 2 HRC
 Patented System

Attention! Machining reference is 24.5

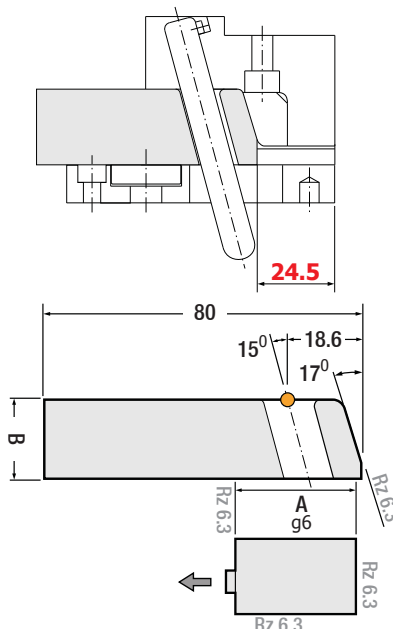

Order	A	B
CA.322080	32	20
CA.322480	32	24
CA.422080	42	20
CA.422480	42	24

Slide Base

Code: BC

The slide retainer is built into the set. Different hardness and materials between CA and BC to guarantees smooth movements. Interchangeable parts. Parts can be replaced from the Parting Line. Hardened and ground, with the correct adjusting tolerances. Incorporates a magnetic Retainer (RM) which must be installed after the slide adjustment and allows fixing the slide movement where needed. Minimum space required for installation.

Material: 1.2510
Hardness: 54 ± 2 HRC
 Patented System

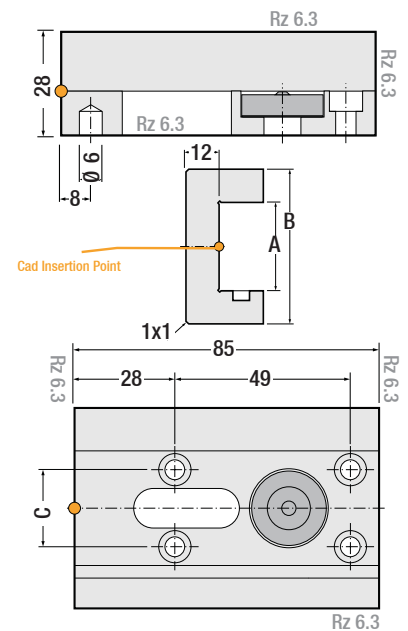

Order	A	B	C
BC.322885	32	56	21.5
BC.422885	42	66	26.5

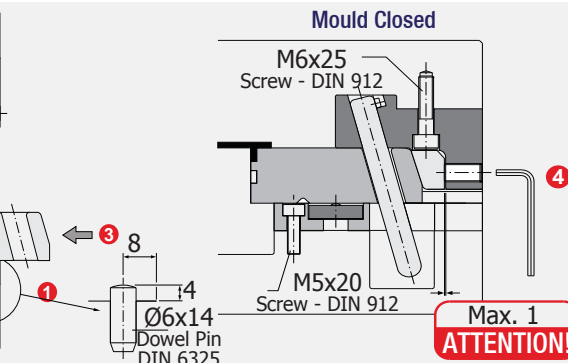
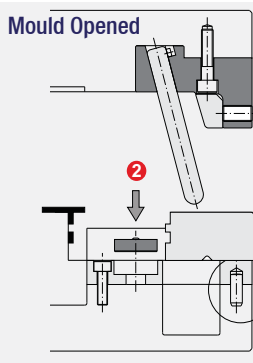

Installation

- 1- Determine the position of BC (slide base) and mount it.
- 2- Place the magnetic retainer into hole.
- 3- Determine the position of CA (adjusted slide).
- 4- While mould is closed, please adjust CA (adjusted slide) up to 1 mm maximum.