

Hidrolik Pabuç "CB"

Kod: 1015 - CB

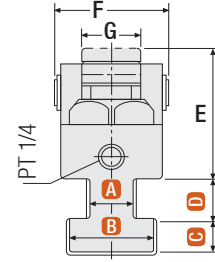

Tip		CB 01	CB 02	CB 04	CB 06	CB 10	CB 16	CB 25
Bağlama Kapasitesi	Ton	1	2	4	6	10	16	25
Toplam Strok (X)	mm	6	8	8	8	8	8	8
Pabuç Strok (Y)	mm	2.5	3	3	3	3	3	3
Muhafaza Edilen Strok (Z)	mm	3.5	5	5	5	5	5	5
Silindirin Toplam Hacmi	cc	3	7.5	13	21	38	55	98

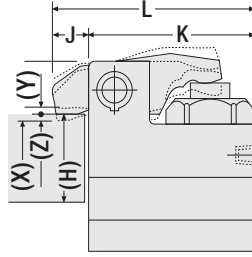
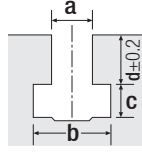
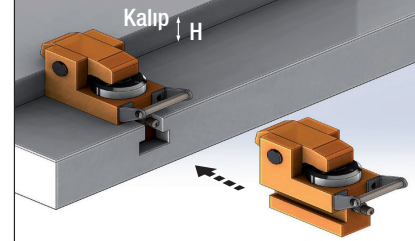

Sipariş Kodu	L	K	J	H	H + d Min. Max.	E Min.	F	G	a Min.	c Min.	P
1015 - CB01	74.5	60	14.5	25	100	42	44	20	10	6.5	PT 1/8
1015 - CB02	110	90	20		100	73	68	32	14	10	PT 1/4
1015 - CB04	134	110	24		130	77	79	40	18	12	
1015 - CB06	159	130	29	30	150	92	96	46	22	14	
1015 - CB10	189	159	30	40	140	114	117	54	24	16	
1015 - CB16	230	200			130	126	129	58	28	20	
1015 - CB25	265	235			45	120	148	156	70	36	23

Hidrolik Basınç: 250 Kgf / cm²

* Sipariş öncesinde; T-Kanal ölçülerini (a-b-c-d) ve kalıp tabanı kalınlığını (H) bildiriniz.

- Pabuç ölçüleri **A, B, C** ve **D** T-Kanala bağlı olarak belirlenir.

Standart Sıcaklık: 60°
Opsiyonel Sıcaklık: 160°

Hidrolik Pabuç "CC"

Kod: 1015 - CC

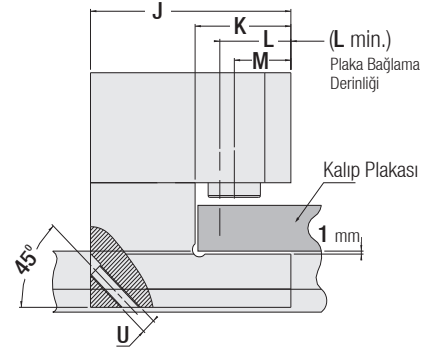
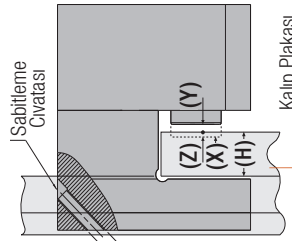
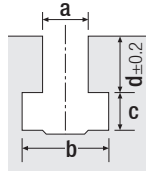

Tip		CC 01	CC 02	CC 04	CC 06	CC 10
Bağlama Kapasitesi	Ton	1	2	4	6	10
Toplam Strok (X)	mm	9	9	9	12	12
Pabuç Strok (Y)	mm	4	4	4	4	4
Muhafaza Edilen Strok (Z)	mm	5	5	5	8	8
Silindirin Toplam Hacmi	cc	3	7.5	13	21	38

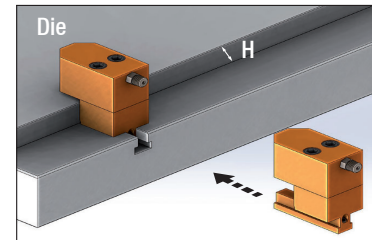
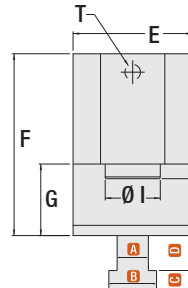

Sipariş Kodu	H Min. - Max.	A Min.	C Min.	E	F	G	I	J	K	L Min.	M	T	U (metrik)
1015 - CC01	20 - 35	10	6.5	43	G+43	H+9	16	75	33	27	21.5	1/8	M5
1015 - CC02	25 - 40	14	10	50	G+50		18	91	43	30	25		M8
1015 - CC04		18	12	65	G+60		30	115	55	40	32.5	M10	
1015 - CC06	35 - 55	22	14	80	G+65	H+12	37.5	130	65	48	40	1/4	M10
1015 - CC10	40 - 60	24	16	100	G+82		50	160	85	60	49		M12

Hidrolik Basınç: 250 Kgf / cm²

* Sipariş öncesinde; T-Kanal ölçülerini (a-b-c-d) ve kalıp tabanı kalınlığını (H) bildiriniz.

- Pabuç ölçüleri **A, B, C** ve **D** T-Kanala bağlı olarak belirlenir.

Standart Sıcaklık: 60°
Opsiyonel Sıcaklık: 160°