

### Spoked Handwheel - Plastic

Code: **GV**

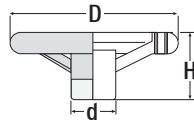

Order Code	D (mm)	H (mm)	d (mm)	Handle Hole
GV100	100	40	30	M8
GV125	125	45	30	M8
GV150	150	50	50	M10
GV200	200	55	50	M10

### Spoked Handwheel - Aluminium

Code: **GEAV**

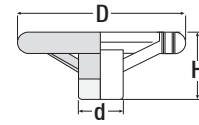

Order Code	D (mm)	H (mm)	d (mm)
GEAV80	80	28	24
GEAV100	100	35	25
GEAV125	125	38	28
GEAV150	150	40	33
GEAV200	200	45	40
GEAV250	250	65	50

### Spoked Handwheel with Handle - Plastic

Code: **GV2**

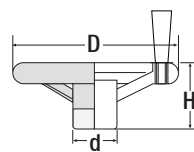

Order Code	D (mm)	H (mm)	d (mm)	Handle Hole	Revolving Handle
GV2100	100	40	30	M8	GPDS12
GV2125	125	45	30	M8	GPDS12
GV2150	150	50	50	M10	GPDS13
GV2200	200	55	50	M10	GPDS13

### Spoked Handwheel - Aluminium

Code: **GEAV2**



\* Black painted

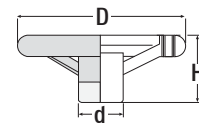

Order Code	D (mm)	H (mm)	d (mm)
GEAV280	80	28	24
GEAV2100	100	35	25
GEAV2125	125	38	28
GEAV2150	150	40	33
GEAV2200	200	45	40
GEAV2250	250	65	50

### Spoked Handwheel - Plastic

Code: **GEPV**

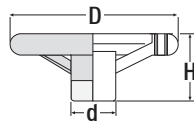

Order Code	D (mm)	H (mm)	d (mm)	Handle Hole
GEPV100	100	40	30	M6
GEPV125	125	50	40	M6
GEPV150	150	60	50	M8
GEPV175	175	65	50	M10
GEPV200	200	70	50	M10

### Spoked Handwheel - Cast Iron

Code: **GEDV**

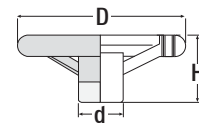

Order Code	D (mm)	H (mm)	d (mm)
GEDV100	100	35	30
GEDV125	125	40	40
GEDV150	150	45	45
GEDV200	200	50	50

### Spoked Handwheel with Handle - Plastic

Code: **GEPV2**

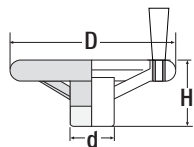

Order Code	D (mm)	H (mm)	d (mm)	Handle Hole	Revolving Handle
GEPV2100	100	40	30	M6	GPDS11
GEPV2125	125	50	40	M6	GPDS11
GEPV2150	150	60	50	M8	GPDS12
GEPV2175	175	65	50	M10	GPDS13
GEPV2200	200	70	50	M10	GPDS13

### Spoked Handwheel - Cast Iron

Code: **GEDV2**



\* Black painted

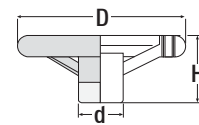

Order Code	D (mm)	H (mm)	d (mm)
GEDV2100	100	35	30
GEDV2125	125	40	40
GEDV2150	150	45	45
GEDV2200	200	50	50