

Double Rack Lifter System

Code: DR

De-moulding strokes from 14mm to 60mm. Significant reduction to the ejection stroke. "Mirror" parts available for 1+1 cavities moulds.

In Mounting: Fast delivery of the required draft. Vertical function maximizing strength. Complete flexibility for the moulding insert dimension. Eliminates the need for high-precision angled housings in the core plates. Smaller and less expensive injection machine required. Possibility to produce angles bigger than $\pm 20^\circ$ upon request. Big savings in time & cost for machining and adjustments.

Stroke (Value): 14mm.
Undercut Width (Value): 70mm.
Ejection Stroke: 100mm.
Mechanism Type: Mechanical
Cooling Available: Yes
Max. Undercut Degrees: $+35^\circ$
Min. Undercut Degrees: -55°

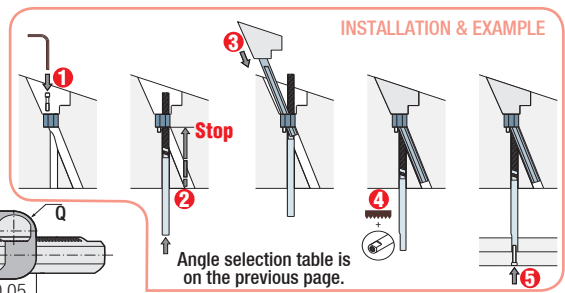
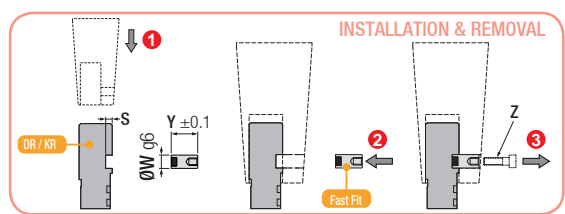
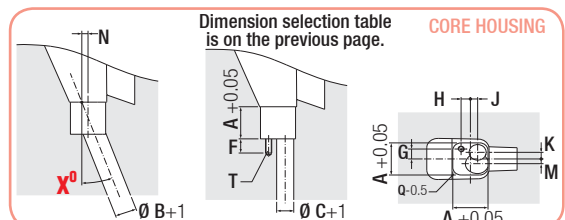
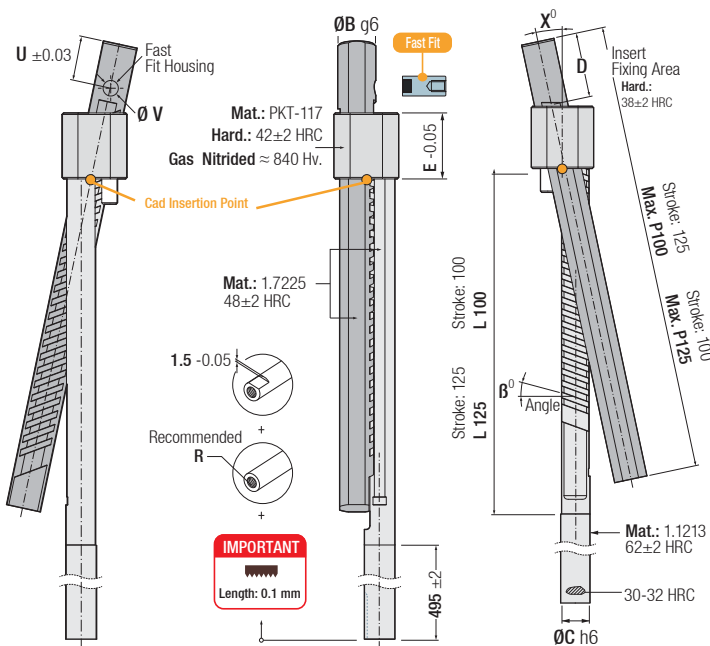

Order "Stroke 100"	Order "Stroke 125"	X°	A	B
DR16100L-X	-			
DR22100L-X	DR22125L-X	12	22	12
DR28100L-X	DR28125L-X	16	28	16
DR34100L-X	DR34125L-X		34	20
DR40100L-X	DR40125L-X	20	40	22
DR46100L-X	DR46125L-X		46	24

IMPORTANT Mirror Part "S" letter is added to the end of order code for Mirror Part.

C	D	E	L100	P100	L125	P125	Q	R	T	U	V	Order: Stroke 100 - S	Order: Stroke 125 - S
8	20	20	142	178	-	-	4	M4	M5	10	6	DR16100L-X-S	-
12	30	22	148	202	202	261	6.5	M6	M6	17	8	DR22100L-X-S	DR22125L-X-S
14	36	28	152.5	214	194.5	266	8.5	M8	M8	23	8	DR28100L-X-S	DR28125L-X-S
16	36	34	160.5	227	188.5	264	10.5	M10	M8	23	8	DR34100L-X-S	DR34125L-X-S
20	36	40	170	244	204	284	10.5	M12	M10	20	10	DR40100L-X-S	DR40125L-X-S
24	42	46	175	258	201	289	10.5	M16	M12	26	10	DR46100L-X-S	DR46125L-X-S

IMPORTANT!
 When ordering, replace the x in the reference with the required X° dimension (8° , 12° , 16° or 20°) and indicate the required β° .