

Kod: PYP

Poliüretan, Kılavuz Kolonu

Poliüretan Yayları kılavuzlamada kullanılan allen başlı kılavuz kolonları.

d1	L1	d2	L2	S	Yay Ø
Ø 6 mm	20	M4	6 mm	3	Ø 16 x 6.5
	25				
	32				
Ø 8 mm	25	M6	9 mm	4	Ø 20 x 8.5
	32				
	40				
	50				
Ø 10 mm	25	M8	15 mm	5	Ø 25 x 10.5
	32				
	40				
	50				
Ø 13 mm	63	M10	15 mm	6	Ø 32 /40 x 13.5
	80				
	95				
	118				
	140				
Ø 16 mm	32	M12	18 mm	8	Ø 50 /63 x 17
	40				
	50				
	63				
	80				
	95				
	118				
Ø 20 mm	140	M16	25 mm	10	Ø 80 /100 x 21
	180				



Sipariş: PYP. d1 x L1

Malzeme: CK45

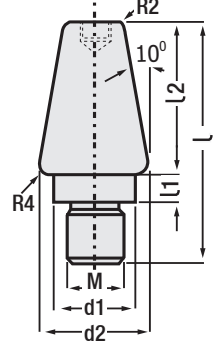
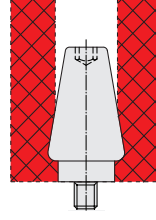
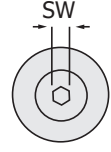

Poliüretan, Merkezleme Pimi - Dişli

Kod: PSP

M	L	d1	d2	L1	L2	SW	Yay Ø
M12	56	19	28	8	30	6	63
M16	74	22	32	10	40	8	80 - 100
M20	100	28	38	15	55	10	125 - 140



Sipariş: PSP. M x L

Malzeme:
1.7131 (16MnCr5)

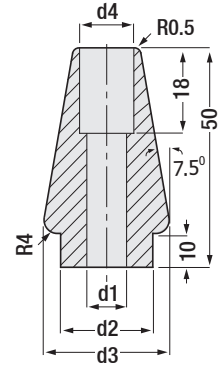
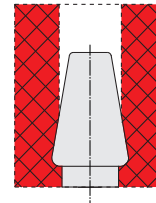

Poliüretan, Merkezleme Pimi

Kod: PMV

M	d1	d2	d3	d4	Yay Ø
M10	11	18	28	17	63
M12	13.5	22	32	19	80 - 100
M16	17.5	28	38	25	125



Sipariş: PMV. M

Malzeme:
1.7131 (16MnCr5)



Bağlantı Cıvataları: M10 x 50 - M12 x 50 - M16 x 60

Poliüretan yaylar için merkezleme pimi.
Üstten vidalı tip.