

Cam Driver Plate, VDI 3357

Code: **G109**

Self-Lub. Angular Wear Plates for Upper and Lower Body of Cam Units

Tolerance between hole distances is ± 0.25 .
 ± 0.25 is used for all dimensions where tolerance is not specified.

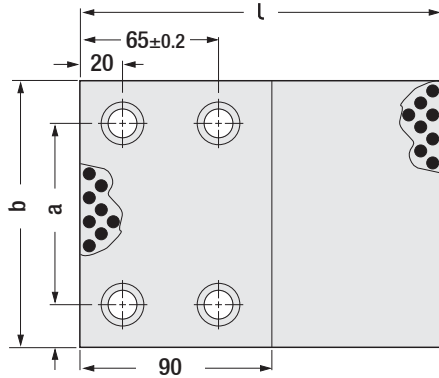
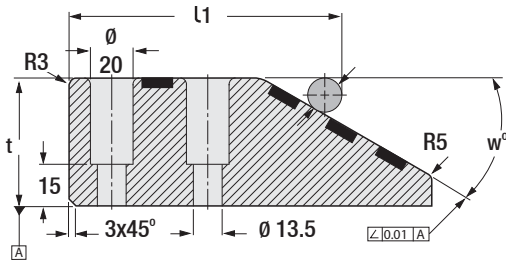

Code: **G109**

b	l	t	l1	a	w
100	170	45	143.37	60	20 ⁰
125	170	45	143.37	85	20 ⁰
150	170	45	143.37	110	20 ⁰
100	150	45	127.86	60	30 ⁰
100	170	60	127.86	60	30 ⁰
125	150	45	127.86	85	30 ⁰
125	170	60	127.86	85	30 ⁰
150	150	45	127.86	110	30 ⁰
150	170	60	127.86	110	30 ⁰

Cam Driver Plate, VDI 3357

Code: **G109C**

Steel Type, Angular Wear Plates for Upper and Lower Body of Cam Units

Tolerance between hole distances is ± 0.25 .
 ± 0.25 is used for all dimensions where tolerance is not specified.

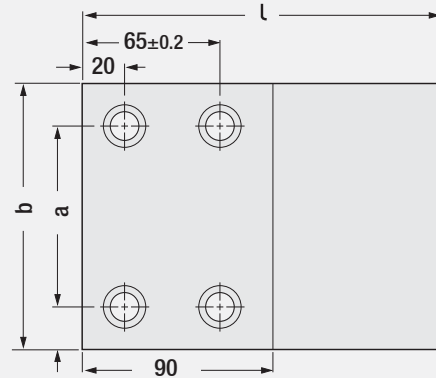
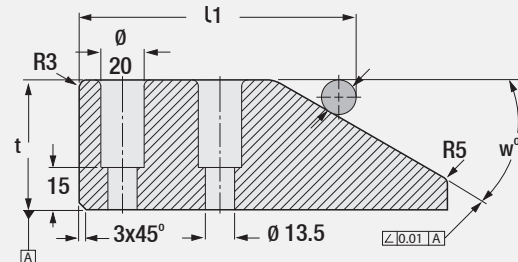

Code: **G109C**

b	l	t	l1	a	w
100	170	45	143.37	60	20 ⁰
125	170	45	143.37	85	20 ⁰
150	170	45	143.37	110	20 ⁰
200	170	45	143.37	160	20 ⁰
100	150	45	127.86	60	30 ⁰
100	170	60	127.86	60	30 ⁰
125	150	45	127.86	85	30 ⁰
125	170	60	127.86	85	30 ⁰
150	150	45	127.86	110	30 ⁰
150	170	60	127.86	110	30 ⁰
200	150	45	127.86	160	30 ⁰
200	170	60	127.86	160	30 ⁰

Order: **G109**. b x l x t

Material: Bronze + graphite inserts

Material: 1.2379
Steel Hardness: 63 - 65 HRC

Order: **G109C**. b x l x t