



Guide Pillar for Cast Block Bush
Flange Cast Bush - Rectangular

Code: **G20**

Code: **G79**

G20 Guide pillar type using with G80 rectangular flange cast bush. In progressive form dies, it is reduced disassembly / assembly period of guide pillar & bush. No need to opening of guide pillar & bush holes in die is required. It reduces labor cost and also saves time by shortening production period of die. These are die components consisting of guide bush set inserted into lower and upper case.

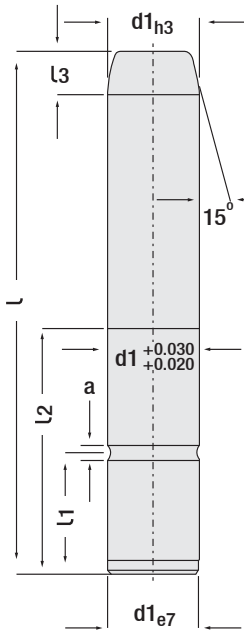

Flange Cast Bush Rectangular
 Code: **G79**

Inner has been honed to $\varnothing d + 0.015$
 Dimension details of rectangular flange cast bush are same as other bushes (G80..)

Order: **G79. d1**

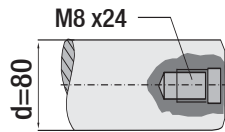

Guide Pillar

Code: **G20**

\varnothing d1	l mm	l1	l2	a	l3
40	180	37	77	8	10
	220				
	260				
	300				
	355				
50	200	47	95	8	10
	240				
	280				
	315				
	355				
63	240	60	120	8	12
	280				
	315				
	355				
	400				
80	240	60	120	8	16
	280				
	315				
	355				
	400				
	450				
	500				

Order: **G20. d1 x L**
 Cast Bush: **G79 x d1**

Material: 1.1213 (Cf53)
 Hardness: 58 - 62 HRC

IMPORTANT: Check perpendicularity of guide pillars after mounting.



Note: Other guide pillars conforming to rectangular flange cast bush connection. It can be used with G03 - G09 - G24 - G10 - G20 in dies.

