

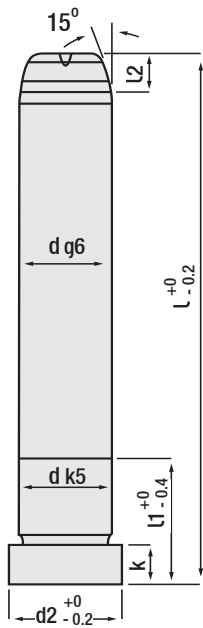

Guide Pillar (without oil groove) Code: **G17**

It is suitable as ejector plates and core systems in injection moulds and as die inner guide pillar in dies. It is compatible using with self-lubricating bronze bushes or bushing components with oil groove.



d	l	l1	l2	d2	k
10	40	13	4	12	3
	60				
	80				
	100	15			
	120				
	140				
12	40	18	4	16	6
	60				
	80				
	100	22			
	120				
	140				
14	60	22	4	18	8
	80				
	100				
	120	26			
	140				
	160				
16	40	16	7	20	8
	60				
	80				
	100	24			
	120				
	140				
18	60	26	7	22	8
	80				
	100				
	120	28			
	140				
	160				
20	60	32	7	24	8
	80				
	100				
	120	37			
	140				
	160				
22	80	43	7	26	15
	100				
	120				
	140	44			
	160				
	180				
24	80	39	7	28	15
	100				
	120				
	140	45			
	160				
	180				
25	80	35	7	28	15
	100				
	120				
	140	44			
	160				
	180				
30	100	45	7	36	15
	120				
	140				
	160	53			
	180				
	200				
40	160	55	10	48	15
	180				
	200				
	220	63			
	240				
	280				
50	160	65	10	58	15
	200				
	240				
	300				
	360				

d	l	l1	l2	d2	k
18	60	26	7	22	8
	80				
	100				
	120	28			
	140				
	160				
20	60	32	7	24	8
	80				
	100				
	120	37			
	140				
	160				
22	80	43	7	26	15
	100				
	120				
	140	44			
	160				
	180				
24	80	39	7	28	15
	100				
	120				
	140	45			
	160				
	180				
25	80	35	7	28	15
	100				
	120				
	140	44			
	160				
	180				
30	100	45	7	36	15
	120				
	140				
	160	53			
	180				
	200				
40	160	55	10	48	15
	180				
	200				
	220	63			
	240				
	280				
50	160	65	10	58	15
	200				
	240				
	300				
	360				

d	l	l1	l2	d2	k
24	80	39	7	28	15
	100				
	120				
	140	45			
	160				
	180				
25	80	35	7	28	15
	100				
	120				
	140	44			
	160				
	180				
30	100	45	7	36	15
	120				
	140				
	160	53			
	180				
	200				
40	160	55	10	48	15
	180				
	200				
	220	63			
	240				
	280				
50	160	65	10	58	15
	200				
	240				
	300				
	360				

NEW
Note: Ø 25 Series are added in our stocks.

GTH guide pillars are polished with surface polishing machine at final stage of production (after grinding).

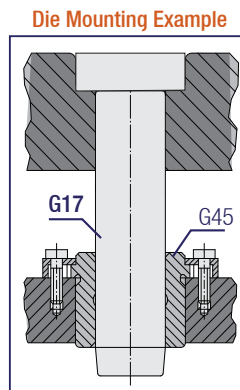
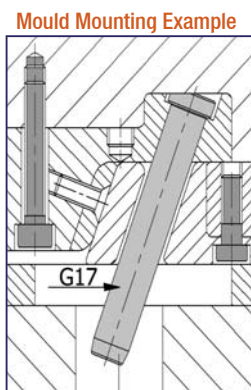
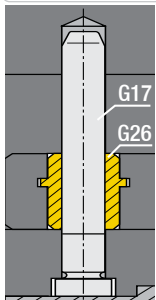

Order: **G17. d x l**

Material: < Ø 20 = 1.7131
> Ø 20 = 1.1213 (Cf53)
Hardness: 58 - 62 HRC

Operating Components: with all lubricated type bushes in injection moulds / dies.