

Compact Perpendicular Connecting 1280 Heightening Bush

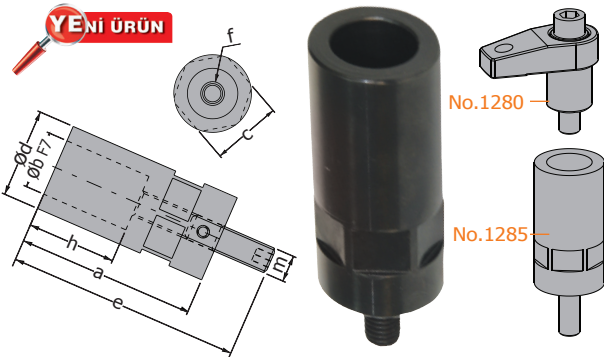

Combined Bushed Clamp;The jig clamp, connecting screw is combined in one unit and is designed with compact connecting system in protective bush, **the heightening** bush is used to connect higher work pieces related to this product. Thus, the long dimensional combined connecting system is completed.

Order 1285	a mm	b F7	c mm	d mm	e mm	f mm	m	h mm	Weight kg.
12080	80	26 mm	36 mm	40 mm	110	M 12	M 12	40 mm	0.60
12100	100	26 mm	36 mm	40 mm	130	M 12	M 12		0.80
16080	80	32 mm	46 mm	50 mm	110	M 16	M 16		0.83
16100	100	32 mm	46 mm	50 mm	130	M 16	M 16	1.20	

Long "T" Channel Element Nut

Material: Ck 45 DIN
Hardness: 30 - 32 HRC
Appearance: Black Plated

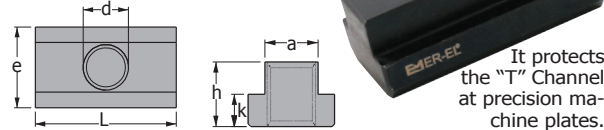

It protects the "T" Channel at precision machine plates.

Order 1710	dx	a mm	e mm	L mm	h mm	k mm	Weight kg.
0608	M6x8	7.7	13	26	10	6	0.02
0810	M8x10	9.7	15	30	12	6	0.03
1012	M10x12	11.7	18	36	14	7	0.05
1214	M12x14	13.7	22	44	16	8	0.08
1416	M14x16	15.7	25	50	18	9	0.10
1618	M16x18	17.7	28	56	20	10	0.17
1820	M18x20	19.7	32	64	24	12	0.26
2022	M20x22	21.7	35	70	28	14	0.36
2224	M22x24	23.7	40	80	32	16	0.55
2428	M24x28	27.7	44	88	36	18	0.73
3036	M30x36	35.6	54	108	44	22	1.40

Compact Perpendicular Connecting 1280

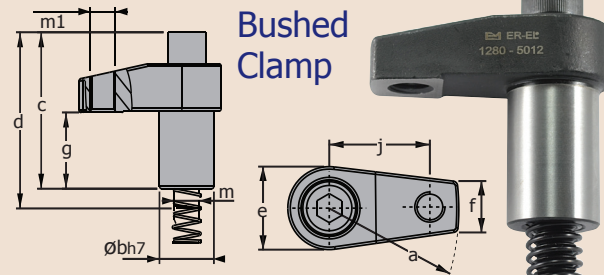

Compact Bushed Clamp 1280,

a	b	c	m
22	30	20	M10
26	40	25	M12
32	40	25	M16

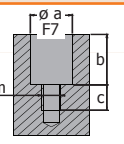

Application Size to Plate

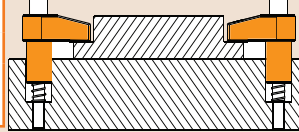

It provides connecting safety with fast and short installation and working opportunity at restricted areas, "T" channels or seat plates and also all kinds of equipment of machine tools.

Order 1280	a mm	ϕb h7	c mm	d mm	e mm	f mm	g mm	Thread M	m1	j mm	Weight kg.
3010	30	22	58	80	28	16	30	M 10	M 8	23	0.20
5012	50	26	70	90	32	20	40	M 12	M 12	40	0.35
6016	60	32	74	95	40	25	40	M 16	M 16	45	0.61

Compact Connection & Moveable Press Element

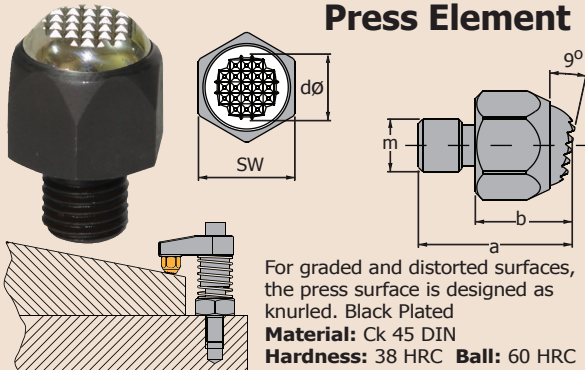

For graded and distorted surfaces, the press surface is designed as knurled. Black Plated
Material: Ck 45 DIN
Hardness: 38 HRC **Ball:** 60 HRC

Order 1283	a mm	b mm	Metric m	d mm	SW	Weight kg.
0825	25	12	M 8	8	14	0.02
1030	30	17	M 10	10	17	0.03
1235	35	22	M 12	12	22	0.07
1642	42	26	M 16	14	27	0.14

Compact Perpendicular Coupling 1275

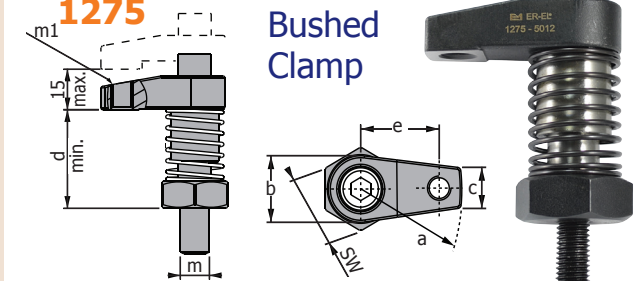

Combine Bushed Clamp: the design with combination connecting force, perpendicular effect connecting system, non-gradual and resistless connection. The fishplate without loosen pieces, compact connecting jaw, protruding part always remains at the adjusted height with a spring, thus the damages are prevented due to that connecting clamp does not fall down on the machine tool during disassembling. The adjustments can be done with clamping bolt (imbus bolt) by single motion.

The combined bushed clamp presents working feature in restricted areas, compact connection, also powerful coupling system installation is completed with hexagon nut and robust and rigid clamping.

Order 1275	a mm	b mm	c mm	d mm	e mm	Metric m	SW	Metric m1	Weight kg.
3012	30	28	16	40	23	M 12	30	M 8	0.29
5012	50	32	20	45	40	M 12	36	M 12	0.50
5016	50	32	20	45	40	M 16	36	M 12	0.50
6016	60	40	25	45	45	M 16	41	M 16	0.75

Compact coupling & Moveable Head Press Element

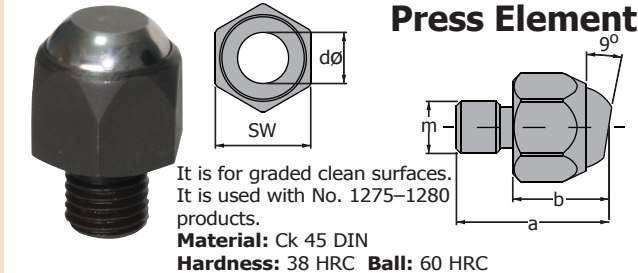

It is for graded clean surfaces. It is used with No. 1275-1280 products.
Material: Ck 45 DIN
Hardness: 38 HRC **Ball:** 60 HRC

Order 1282	a mm	b mm	Metric m	d mm	SW	Weight kg.
0825	25	12	M 8	8	14	0.02
1030	30	17	M 10	10	17	0.03
1235	35	22	M 12	12	22	0.07
1642	42	26	M 16	14	27	0.14



COMPACT, JIG TOOLS