

Fixed Lifter Base

Code: **DF**

Keyed pocket for the lifter shaft. Minimum space required in the ejector plates. "VI" (Lifter Shaft) may be used as ejector.

Material: INOX 1.4034
Hardness: 48 ± 2 HRC

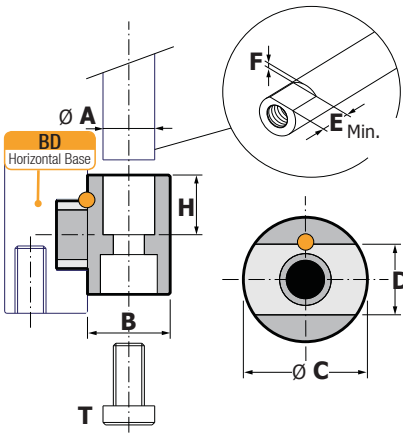

● Cad Insertion Point

Code: **DF**

Order	A	B	C	D
DF.061220	6	12	20	11.5
DF.081220	8	12	20	11.5
DF.101624	10	16	24	13.5
DF.121624	12	16	24	13.5
DF.162032	16	20	32	19
DF.202538	20	25	38	21
DF.253148	25	31	48	28

E	F	H	T
12	0.5	10	M4 x 12
12	0.5	10	M5 x 12
14	0.5	12	M6 x 16
14	1.0	12	M8 x 16
18	1.5	16	M8 x 22
21	1.5	19	M10 x 25
26	2.0	24	M12 x 35

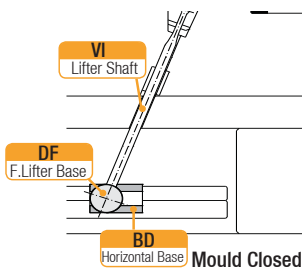

Adjustable Lifter Base

Code: **DA**

Keyed pocket for the lifter shaft. Minimum space required in the ejector plates. "DA" Allows easy adjustment of the lifter shaft height.

Material: INOX 1.4034
Hardness: 48 ± 2 HRC

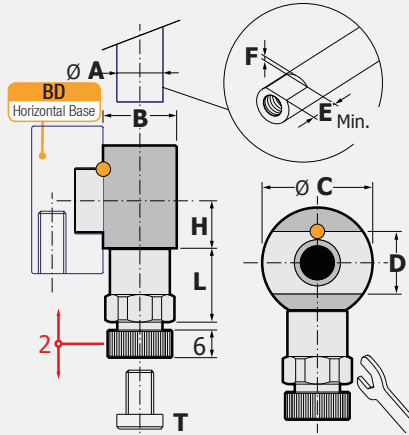

Code: **DA**

Order	A	B	C	D
DA.061020	6	10	20	11.5
DA.081220	8	12	20	11.5
DA.101624	10	16	24	13.5
DA.121824	12	18	24	13.5

E	F	H	L	T
15	0.5	9.0	14	M4 x 40
15	0.5	8.5	14	M5 x 40
17	0.5	10.2	16	M6 x 40
17	1.0	9.6	16	M8 x 40

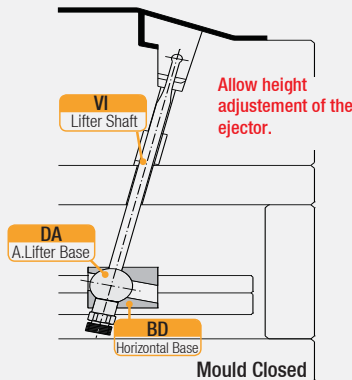

Lifter Head

Code: **IF**

Lifter Head hardened and ground to size. No need for threads or dowel pins to attach the Lifter Head to the Lifter Shaft. Offers a standard solution to the mould makers.

Material: 1.2344
Hardness: 45 ± 2 HRC

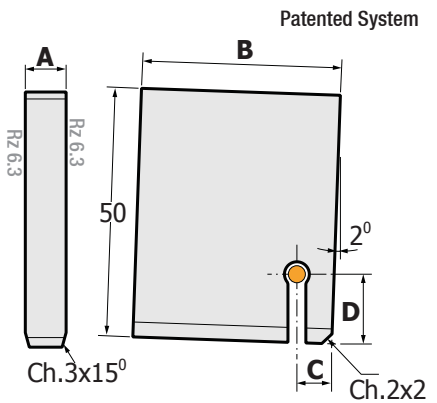

Code: **IF**

Order	A	B	C	D
IF.064050	6.2	40	6	12
IF.084050	8.2	40	7	14
IF.104450	10.2	44	8	16
IF.124450	12.2	44	9	18

R	X	Y	Z
40	5	3.5	36
38	10	6.7	35
38	15	10.2	34
37	20	13.5	32

