

Hose Fitting

Code: **FHR**

Material = Brass
 Operating Pressure = 0 - 15 bar
 Flow Capacity = 8 mm
 Operating Temperature = -5 / +180°

Order Code	d	d1	d2	l	l1	SW
FHR.1310	G 1/4"	5.5	9.5	43	28	17
FHR.1313	G 1/4"	8	12.5	43	28	17
FHR.1710	G 3/8"	5.5	9.5	46	33	19
FHR.1713	G 3/8"	8	12.5	46	33	19
FHR.2113	G 1/2"	8	12.5	46	33	23

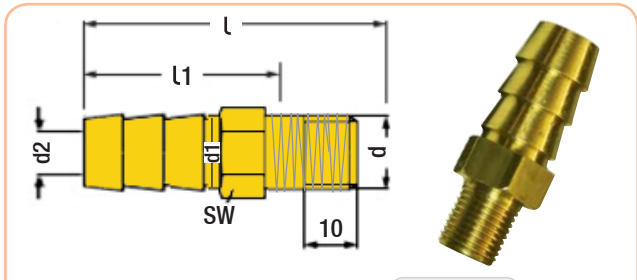

Hose Fitting

Code: **HRE**

Material = Brass
 Operating Pressure = 0 - 15 bar
 Flow Capacity = 8 mm
 Operating Temperature = -5 / +180°

Order Code	d	d1	d2	l	l1	SW
HRE.M8	M8 x 1.25	12	7	36	28	13
HRE.M10	M10 x 1.50			36		13
HRE.M12	M12 x 1.75			40		13
HRE.M14	M14 x 2.0			40		14
HRE.M16	M16 x 2.0			40		16
HRE.1/8"	G 1/8"			36		13
HRE.1/4"	G 1/4"	40	28	14		
HRE.3/8"	G 3/8"	40	17			

Rubber Hose

Code: **FLEX**

It is resistant to bending with its flexible structure reinforced with polyester for hot and cold water. It is suitable to be used according to fitting feature / with our without clamp.



Order Code	Inner Ø	Outer Ø	Operating Pressure	Blast Pressure	Roll Length	Colour
FLEX.10B	9.5	15.4	28 Bar	60 Bar	20 Metre	Blue
FLEX.10R	9.5	15.4				Red
FLEX.13B	12.5	18.5				Blue
FLEX.13R	12.5	18.5				Red

Operating Temp. = -20 / +90° Flow Capacity = 9.5 / 12.5 mm

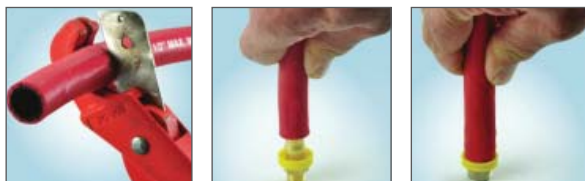

Cut hose end straightly in desired length. Insert hose into fitting. Insert hose into plastic yellow slot by pushing hose settled on fitting.

There is no need to insert clamp in this way. You need to cut hose end in order to remove hose from fitting.

Extension Fitting with Thread

Code: **ARU**

Order Code	d	l	SW
ARU.18.60	G 1/8"	60	14
ARU.18.80		80	
ARU.18.100		100	
ARU.18.150		150	
ARU.14.60		G 1/4"	
ARU.14.80	80		
ARU.14.100	100		
ARU.14.150	150		

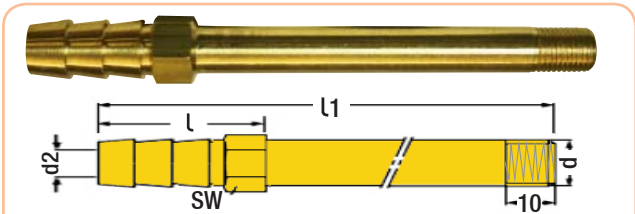

Hose Fitting Long Type

Code: **HRU**

Order Code	d	d1	d2	l	l1	SW
HRU.M08060	M8 x 1.25	12	7	60	28	13
HRU.M08080				80		
HRU.M08100				100		
HRU.M08120				120		
HRU.M08150				150		
HRU.M10060	M10 x 1.5	12	7	60	28	13
HRU.M10080				80		
HRU.M10100				100		
HRU.M10120				120		
HRU.M10150				150		
HRU.M12060	M12 x 1.75	12	7	60	28	13
HRU.M12080				80		
HRU.M12100				100		
HRU.M12120				120		
HRU.M12150				150		
HRU.10.060	G 1/8"	12	7	60	28	13
HRU.10.080				80		
HRU.10.100				100		
HRU.10.120				120		
HRU.10.150				150		
HRU.13.060	G 1/4"	12	7	60	28	14
HRU.13.080				80		
HRU.13.100				100		
HRU.13.120				120		
HRU.13.150				150		

Material = Brass
 Operating Pressure = 0 - 15 bar
 Flow Capacity = 8 mm
 Operating Temp. = -5 / +180°