

Tolerance
h7

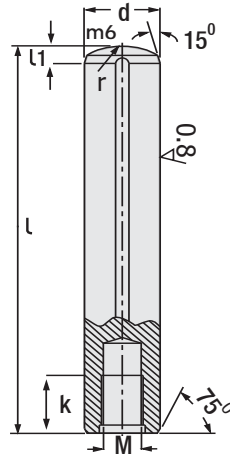

Tolerance
m6



Dowel Pin with Internal Thread
with Air Channel - DIN 7979 / ISO 8735

Code: **CTPh7**

Dowel Pin with Internal Thread
with Air Channel - DIN 7979 / ISO 8735

Code: **CTPm6**

d	l	l1	k	M	r
Ø 6 mm	20	2.1 mm	6 mm	M4	6
	24				
	30				
	36				
	40				
	45				
	50				
	55				
	60				
	70				
	80				
90					
100					
Ø 8 mm	20	2.6 mm	8 mm	M5	8
	24				
	30				
	36				
	40				
	45				
	50				
	55				
	60				
	70				
	80				
90					
100					
120					
Ø10 mm	20	3 mm	10 mm	M6	10
	24				
	30				
	36				
	40				
	45				
	50				
	55				
	60				
	70				
	80				
90					
100					
120					

d	l	l1	k	M	r
Ø12 mm	20	3.8 mm	10 mm	M6	12
	24				
	30				
	36				
	40				
	45				
	50				
	55				
	60				
	70				
	80				
90					
100					
120					
Ø14 mm	30	4 mm	12 mm	M8	14
	36				
	40				
	45				
	50				
	60				
	70				
	80				
	90				
	100				
	120				
140					
Ø16 mm	30	4.7 mm	12 mm	M8	16
	36				
	40				
	45				
	50				
	60				
	70				
	80				
	90				
	100				
	120				
140					
Ø20 mm	30	6 mm	16 mm	M10	20
	36				
	40				
	50				
	60				
	70				
	80				
	90				
	100				
	120				
	150				

d	l	l1	k	M	r
Ø 5 mm	20	1.7 mm	6 mm	M3	5
	24				
	30				
	36				
	40				
	45				
	50				
	55				
	60				
	70				
	80				
Ø 6 mm	20	2.1 mm	6 mm	M4	6
	24				
	30				
	36				
	40				
	45				
	50				
	55				
	60				
	70				
	80				
90					
100					
Ø 8 mm	20	2.6 mm	8 mm	M5	8
	24				
	30				
	36				
	40				
	45				
	50				
	55				
	60				
	70				
	80				
90					
100					
120					
Ø10 mm	20	3 mm	10 mm	M6	10
	24				
	30				
	36				
	40				
	45				
	50				
	55				
	60				
	70				
	80				
90					
100					
120					

d	l	l1	k	M	r
Ø12 mm	20	3.8 mm	10 mm	M6	12
	24				
	30				
	36				
	40				
	45				
	50				
	55				
	60				
	70				
	80				
90					
100					
120					
Ø14 mm	30	4 mm	12 mm	M8	14
	36				
	40				
	45				
	50				
	60				
	70				
	80				
	90				
	100				
	120				
140					
Ø16 mm	30	4.7 mm	12 mm	M8	16
	36				
	40				
	45				
	50				
	60				
	70				
	80				
	90				
	100				
	120				
140					
Ø20 mm	30	6 mm	16 mm	M10	20
	36				
	40				
	50				
	60				
	70				
	80				
	90				
	100				
	120				
	150				

Material: 1.7131 (16MnCr 5)
Hardness: 60 - 62 HRC (Depth 0.8)

Order: **CTPh7. d x l**

Order Example:
CTPh7. 8 x 40

Order: **CTPm6. d x l**