

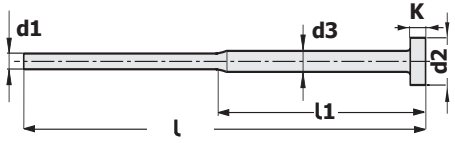

For your order of special dimensions, technical drawing can be used:



**Cylinder Head Stepped Ejector Pin / DIN ISO 8694**

Code: **SBKAH**

Material: 1.2516 WS  
 Heat Resistance: 220° max.  
 Head Hardness: 45 ± 2 HRC  
 Tensile Resistance: 1300 N / mm<sup>2</sup>  
 Body Hardness: 60 ± 2 HRC

As per request / Custom-made orders.

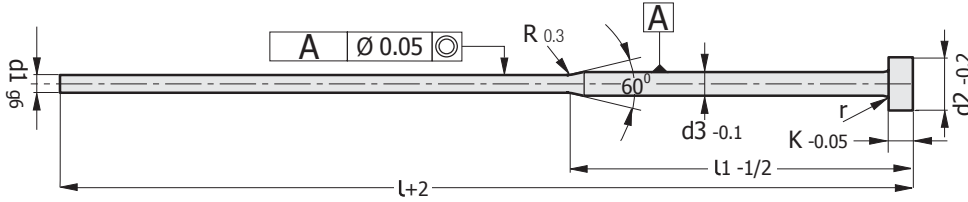

Type: AH

Code: **SBKAH**

d1	l	l1	d3	d2	k	d1	l	l1	d3	d2	k	d1	l	l1	d3	d2	k
<b>0.8</b>	63	25	2	4	2	<b>1.4</b>	63	25	2	4	2	<b>2.0</b>	80	35	3	6	3
	80	35					80	35					100	50			
	100	50					100	50					125	75			
	125						125						150				
	150	75					150	75					160	75			
	160						160						200				
<b>1.0</b>	63	25	2	4	2	<b>1.5</b>	63	25	3	6	3	<b>2.2</b>	80	35	3	6	3
	80	35					80	35					100	50			
	100	50					100	50					125	75			
	125						125						150				
	150	75					150	75					160	75			
	160						160						200				
<b>1.1</b>	63	25	2	4	2	<b>1.6</b>	80	35	3	6	3	<b>2.5</b>	100	50	3	6	3
	80	35					100	50									
	100	50					125						50	150			
	125						125	160						75			
	150	75					150	75					200				
	160						160						200	75			
<b>1.2</b>	63	25	2	4	2	<b>1.7</b>	80	35	3	6	3	<b>2.6</b>	100		50	3	6
	80	35					100	50									
	100	50					125						50	150	75		
	125						125	160						75			
	150	75					150	75					200		75		
	160						160						200	75			
<b>1.3</b>	63	25	2	4	2	<b>1.8</b>	80	35	3	6	3	<b>2.7</b>	100		50	3	6
	80	35					100	50									
	100	50					125						50	150	75		
	125						125	160						75			
	150	75					150	75					200		75		
	160						160						200	75			
<b>1.4</b>	63	25	2	4	2	<b>1.9</b>	80	35	3	6	3	<b>2.8</b>	100		50	3	6
	80	35					100	50									
	100	50					125						50	150	75		
	125						125	160						75			
	150	75					150	75					200		75		
	160						160						200	75			

Order: **SBKAH.** d1 x d3 x l1 x l

Order Example: **SBKAH. 1.4 x 2 x 50 x 100**