

Heavy Duty Stepped Punch with Ejector

Code: **SF..F**
* Larger-headed

Order Codes:

SFYF - SF0F - SFKF - SFDF - SFAF - SFMF - SFXF - SFPF

Please refer to the table on the right side →

Order d3	Head d2	d1 / Shape		Standard L1	Alternative L1		L mm
		(SFYF) Round P	Other Shapes W G/P		Min.	Max.	
SF..F08	13	4.0 ~ 7.99	4.0 - 8	13	13	25	60
SF..F10	15	5.0 ~ 9.99	5.0 - 10	13	13	25	
SF..F13	18	6.0 ~ 12.99	6.0 - 13	13	13	25	70
SF..F16	21	10 ~ 15.99	6.0 - 16	19	13	25	80
SF..F20	25	13 ~ 19.99	6.0 - 20	19	13	25	90
SF..F25	30	18 ~ 24.99	6.0 - 25	19	13	25	100

How to order:

Shape
d3
P/W
L1
L
Material

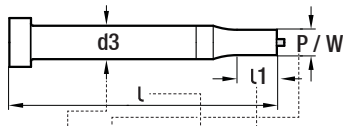

SFYF x 10 x P7.0 x 13 x 80 - M2
SF0F x 10 x P8.2 x W5.2 x 25 x 100 - M2

Shapes

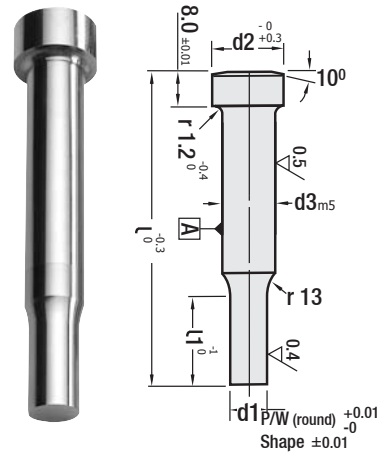
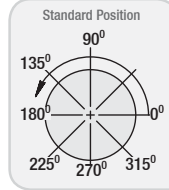
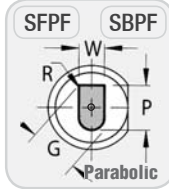
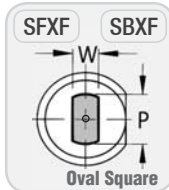
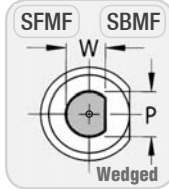
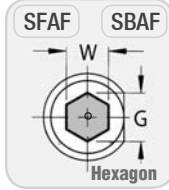
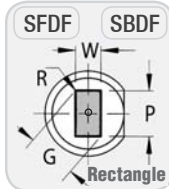
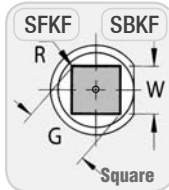
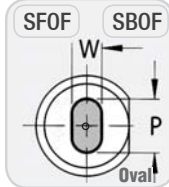
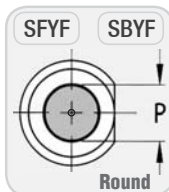

Heavy Duty Stepped Punch

Code: **SB..F**
* Larger-headed

Order Codes:

SBYF - SB0F - SBKF - SBDF - SBAF - SBMF - SBXF - SBPF

← Please refer to the table on the left side

Order d3	Head d2	d1 / Shape		Standard L1	Alternative L1		L mm
		(SBYF) Round P	Other Shapes W G/P		Min.	Max.	
SB..F08	13	3.0 ~ 7.99	3.0 - 8	13	13	25	60
SB..F10	15	3.0 ~ 9.99	3.0 - 10	13	13	25	
SB..F13	18	6.0 ~ 12.99	3.0 - 13	13	13	25	70
SB..F16	21	10 ~ 15.99	4.0 - 16	19	13	25	80
SB..F20	25	13 ~ 19.99	5.0 - 20	19	13	25	90
SB..F25	30	18 ~ 24.99	6.0 - 25	19	13	25	100

How to order:

Shape
d3
P/W
L1
L
Material

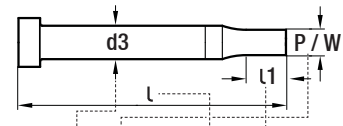

SBYF x 10 x P7.0 x 13 x 80 - M2
SB0F x 10 x P8.2 x W5.2 x 25 x 100 - M2

The standard location of key flats is at 0°. Alternate locations of 90°, 180° or 270° can be specified.