

Accessories for Power Clamps

Fixing Screw and T-Nut

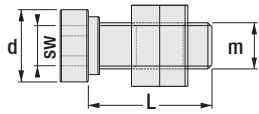

* For 14-28 T-Slots.
* T-Nut DIN 508.

Order Code	a	m	L	d	sw
1120-512	12	M10	29	16.5	8
1120-514	14	M12			
1130-614	14	M12	30	20.5	10
1130-616	16				
1130-618	18				
1130-620	20				
1130-622	22				
1150-718	18	M16	34	24.5	12
1150-720	20				
1150-722	22				
1150-724	24				
1150-728	28				
1160-822	22	M20	45	34	12
1160-824	24				
1160-826	28	M24	55	34	12
1160-828	28				
1160-832	32				
1160-836	36		66	38.5	

Combined Power Sliding Clamp

Code: 1120 / 1130 / 1150 / 1160 - DT

(Type: DT / with Base Support & for T-Slots)

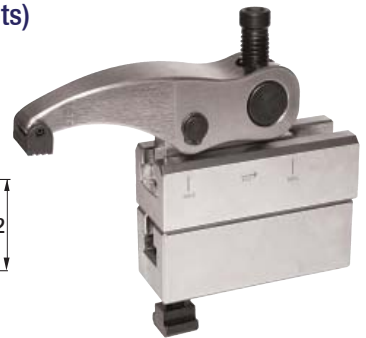
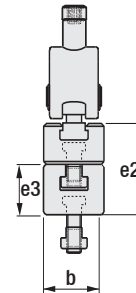
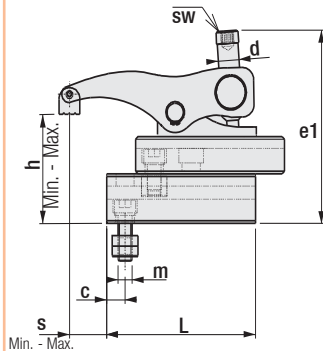

Area of Usage:

Injection machines, presses, milling machines, drilling machines and various industrial machines.

Code: 1120 - DT / Standard Type
(t-slot: 14 - 16 - 18)

- * M12 hex-socket screw is used with DIN 508 T-Nut.
- * Height Clamping Gap of Part: 36 - 86 mm
- * Back and Forth Movement Distance: 54 mm
- * Clamping Force: 1600 Kgf

Code: 1130 - DT / Standard Type
(t-slot: 14 - 16 - 18 - 20 - 22)

- * M12 hex-socket screw is used with DIN 508 T-Nut.
- * Height Clamping Gap of Part: 45 - 105 mm
- * Back and Forth Movement Distance: 68 mm
- * Clamping Force: 2000 Kgf

Code: 1150 - DT / Heavy Duty Type
(t-slot: 18 - 20 - 22 - 24 - 28)

- * M16 hex-socket screw is used with DIN 508 T-Nut.
- * Height Clamping Gap of Part: 48 - 113 mm
- * Back and Forth Movement Distance: 78 mm
- * Clamping Force: 2500 Kgf

Code: 1160 - DT / Heavy Duty Type
(t-slot: 22 - 24 - 28 - 36)

- * M20-24 hex-socket screw is used with DIN 508 T-Nut.
- * Height Clamping Gap of Part: 79 - 139 mm
- * Back and Forth Movement Distance: 75 mm
- * Clamping Force: 5500 Kgf

Pressure Pad



DP: Straight part clamping.



BSP: Lengthwise cylinder clamping.



ESP: Transverse cylinder clamping.

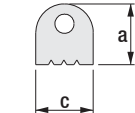
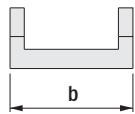

Order Code	a mm	b mm	c mm	Weight (g)
1120-DP	13.5	26.5	12	15
1120-BSP	15.5			18
1120-ESP	18			21
1130-DP	17	32	15	20
1130-BSP	19			30
1130-ESP	22			30
1150-DP	19	38	18	40
1150-BSP	21			50
1150-ESP	25			55
1160-DP	22	44	22	70
1160-BSP	25			70
1160-ESP	28			80

Order Code	T-Slot a	m	h	s	e1	e2	d	sw	L	b	e3	c	Weight (g)
1120-014-DT	14	M12	Min. - Max. 36 - 86	12 - 66	136	71.5	M14	8	104	38	38	13	2540
1120-016-DT	16												
1120-018-DT	18												

1130-014-DT	14	M12	Min. - Max. 45 - 105	15 - 83	158	83	M18	10	130	48	45	17.5	4750
1130-016-DT	16												4775
1130-018-DT	18												4805
1130-020-DT	20												4855
1130-022-DT	22												4905

Heavy Duty Types

1150-118-DT	18	M16	Min. - Max. 48 - 113	18 - 96	173	90	M20	12	140	55	48	19.5	6625
1150-120-DT	20												6690
1150-122-DT	22												6750
1150-124-DT	24												6840
1150-128-DT	28												6960

1160-222-DT	22	M20	Min. - Max. 79 - 139	17 - 92	235	114	M24	12	178	74	59	24	13330
1160-224-DT	24												13465
1160-228-DT	28												13580
1160-236-DT	36												13890

Position and secure the base support on the tool table.



Desired distance is reached by increasing base supports.



Base support is applied in T-Slot with hex-socket screw against T-Nut.



Workpiece is fixed with the hex-socket screw of the clamp.

