

Wheel dressing 

Wheel Dresser Tool Code: VTDB

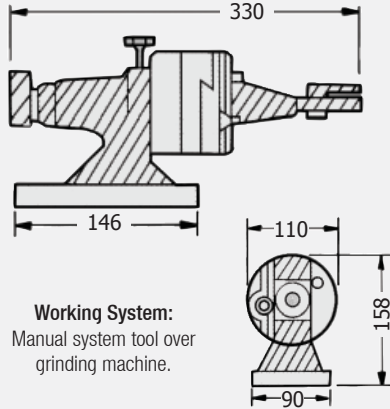

Working System:
Manual system tool over grinding machine.

Convex dressing radius = 0.8 R - 40 R
Concave dressing radius = 0 - 40 R
Max. grinding wheel diameter = Ø 250 mm
Rotation angle = 4 x 90° = 360°
Precision dividing head angle = 6"

- * Precision centre height is obtained with positive cutting angle diamond dressers.
- * Thanks to precision ground dovetail slides, absolute distance shifts are prevented in the desired distance.
- * By providing control from one point, convex and concave dressing forms are provided precisely and quickly.
- * All working surfaces and measuring scale is 60 HRC.

Wheel dressing applications

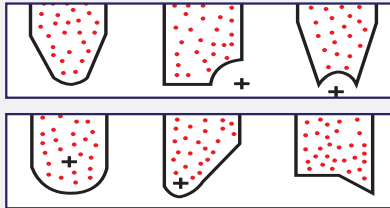

Code: VPGA

Mini Pin & Punch Former Tool

It is suitable to be used at machining and grinding of small diameters and short pins serially.

Pin diameter capacity: From 0.5 to 6 mm
Step distance: 10 mm
Weight: 3.1 Kg.

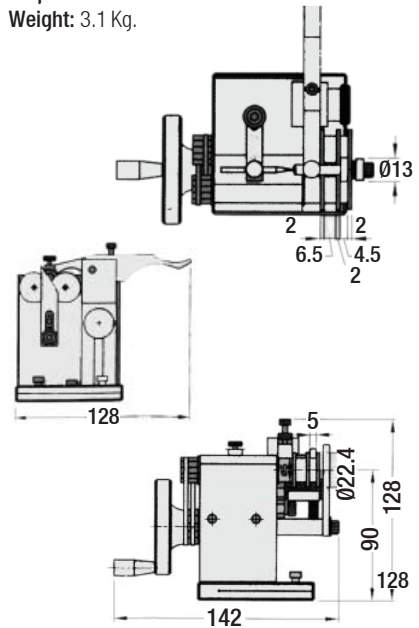

Punch Former Tool Code: V-PB

(Pin bearing length: 22 mm)

Specifications: It creates the shapes / forms of die punches or mould ejector pins or it enables to create the desired formed shapes as equipment manually in shaped forming processing grinding machine manually. Motion is provided in two ways with equipment, it is provided 360° angular return motion and eccentric (up / down) motions processing practicality.

Punch end shape, some forms

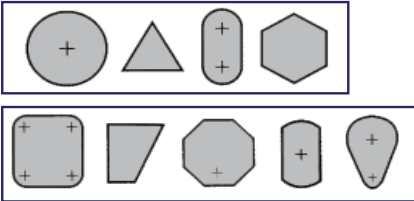

d1: Pin clamping diameter = Ø4 - Ø30 mm
L: Pin clamping length = min. 22 mm
"V" Bearing: Up / down motion = 25 mm
"V" Bearing: One way motion = 12.5 mm
"V" Bearing: Total motion = 25 mm

Equipment surface and angle / scale hardness: 63 HRC
Chuck dividing head angle:
24 Pcs. 15° ± 5°
Total weight: 10 Kg.
Wheel diameter: 200 mm
Chuck dividing head angle:
24 Pcs. 15° ± 5°

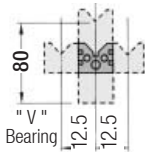

Eccentric rotation setting

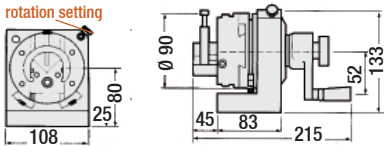

Diamond Wheel Dresser Code: TDE

It is for dressing wheels in grinding machines.

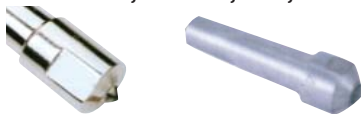

Order	Type / Carat	Order	Type / Carat
TDE.030	0.30	TDE.150	1.5
TDE.050	0.50	TDE.200	2.0
TDE.075	0.75	TDE.250	2.5
TDE.100	1.0	TDE.300	3.0

Sine Plate for Punch Former Tools

Code: VPS-S



Weight: 3.6 Kg.

