

Standard Nozzle Outer Bushing

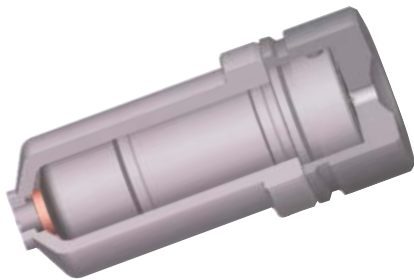

Outer Bushings are used as aid components for additional cooling of Hot Runner Nozzle or for installing our standard products to the incorrectly produced Nozzle slots.

Flat Bushings

It supports Nozzle in bearing and provides sealing on mould edge and nozzle edge.

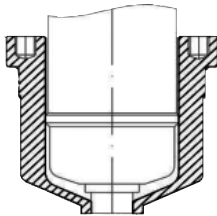

Order Example:

SB - Y02 . ØD1

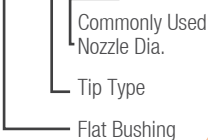

Bushings with Cooling Channel

With o-ring and cooling channels. They provide perfect solutions for cosmetic surfaces.

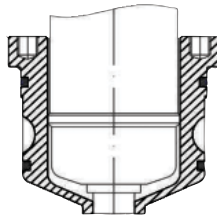

Order Example:

SCB - Y02 . ØD1

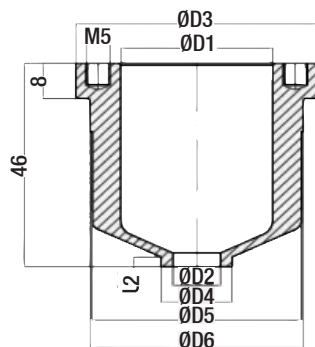
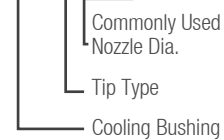

Material: 1.2344
Hardness: 52 HRC

Order Code	D1	D3	D4	L2	Cooling
SB-Y02.25	25	44	13	2	None
SCB-Y02.25					Available
SB-Y02.32	32	51	15	2.2	None
SCB-Y02.32					Available
SB-Y02.40	40	59	19	2.5	None
SCB-Y02.40					Available

Hot Runner System - Assembly Operations of the Nozzles

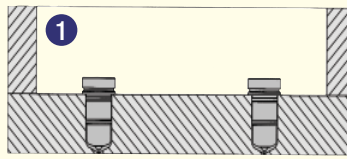

1- Check the nozzle cavities if they are in specified tolerances or not.

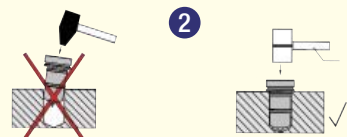

2- Place the nozzle using rubber hammer without sealing plug in balance.

* Do not use iron or steel tools to place the nozzle into cavity. Do not place nozzle crooked and prevent winding.

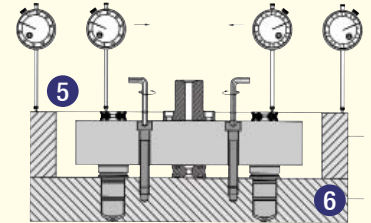

5- Place the manifold and bridge / wedge plates.

6- Tighten manifold fixing screws, slowly and simultaneously by controlling manifold corners.

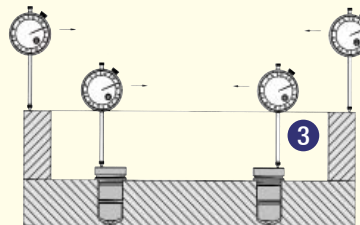

3- Measure nozzle head height with dial gauge and zeroing.

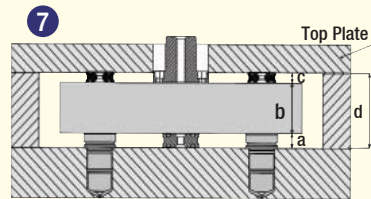

7- Place the top plate.

* For sealing; $a + b + c > d$ sealing can be performed in necessary places.

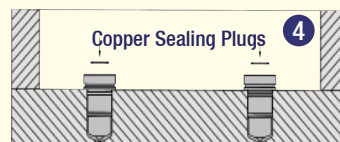

4- Place the copper sealing plugs in the channel top of the nozzles.

Assembly Drawing

