

GC Serisi, Gazlı Yaylar - Basıncı Yüksek

N - Newton = (0.102)Kg. daN - 10 Newton = (1.020)Kg.

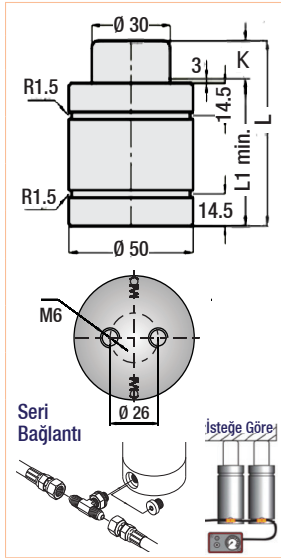

Sipariş Kodu	Strok (K) mm	L1 min.	L Boy	Kuvvet		Ağırlık Kg.
				İlk	Son	
GC.1800.06	6 mm	60	66	1800 Kg.	2700 Kg.	0.62
GC.1800.10	10 mm	70	80			0.68
GC.1800.16	16 mm	90	106			0.80
GC.1800.25	25 mm	110	135			0.92
GC.1800.32	32 mm	130	162			1.05
GC.1800.40	40 mm	150	190			1.17
GC.1800.50	50 mm	170	220			1.30

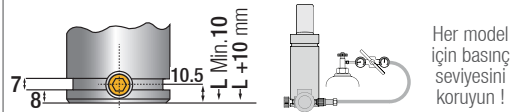
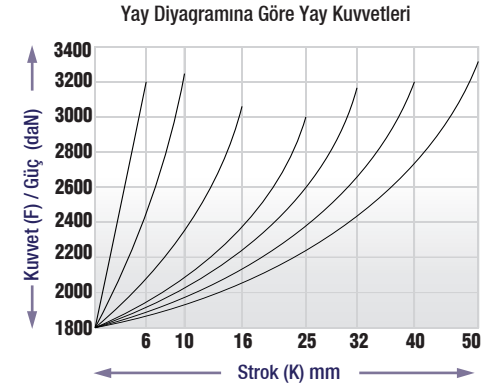
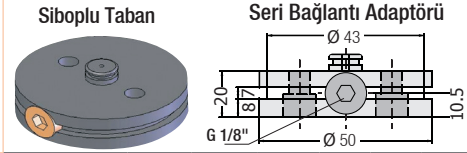

Her model için basınç seviyesini koruyun !

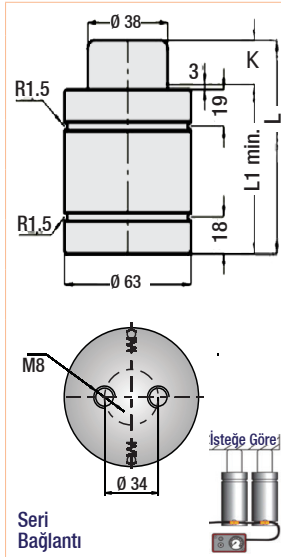

Sipariş Kodu	Strok (K) mm	L1 min.	L Boy	Kuvvet		Ağırlık Kg.
				İlk	Son	
GC.3000.10	10 mm	75	85	3000 Kg.	4650 Kg.	1.23
GC.3000.16	16 mm	87	103			1.35
GC.3000.25	25 mm	105	130			1.54
GC.3000.32	32 mm	118	150			1.68
GC.3000.40	40 mm	135	175			1.86
GC.3000.50	50 mm	155	205			2.07

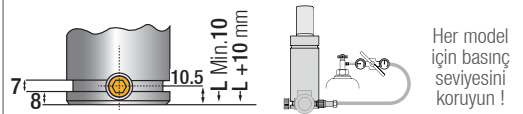
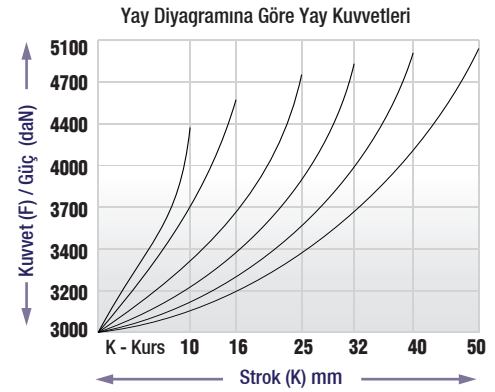
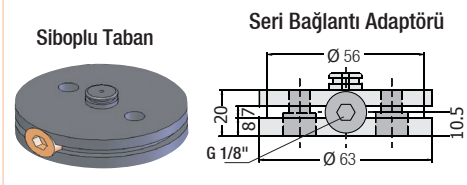

Her model için basınç seviyesini koruyun !

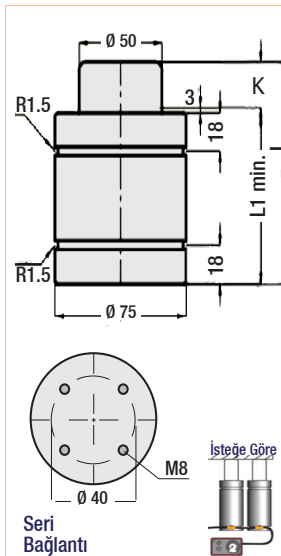

Sipariş Kodu	Strok (K) mm	L1 min.	L Boy	Kuvvet		Ağırlık Kg.
				İlk	Son	
GC.4700.10	10 mm	70	80	4700 Kg.	6350 Kg.	1.60
GC.4700.16	16 mm	90	106			1.83
GC.4700.25	25 mm	110	135			2.07
GC.4700.32	32 mm	135	167			2.37
GC.4700.40	40 mm	160	200			2.66
GC.4700.50	50 mm	190	240			3.01

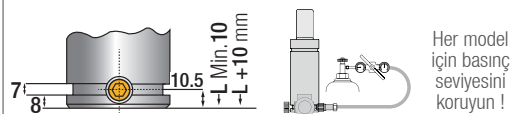
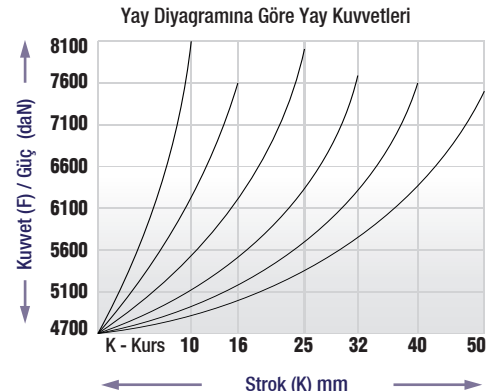
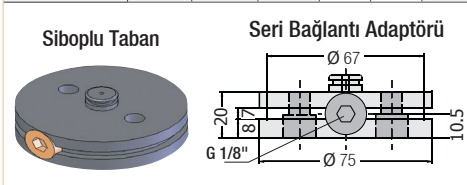

Her model için basınç seviyesini koruyun !

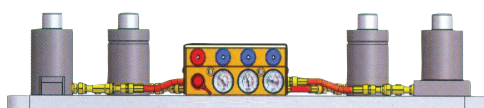

Seri bağlantılı gazlı yayların siparişlerinde; sibop girişlerini 1 veya 2 siboplu olarak bildiriniz.

